

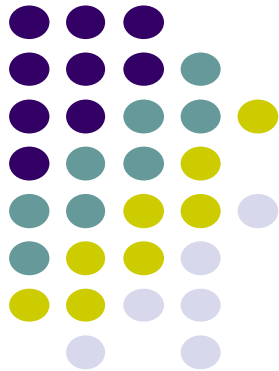

521 & 525 ESSA ROAD

ZONING BYLAW AMENDMENT APPLICATION



DECEMBER 11TH,
2017

PUBLIC MEETING





ENCORE
DEVELOPMENT GROUP

APPLICATION CONTEXT

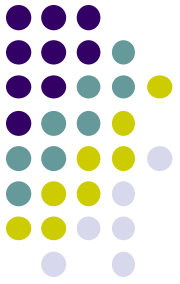

SITE:

- FRONTAGE: 54.86 M (180 FT)
- AREA: 0.45 HA (1.12 ACRES)
- TWO EXISTING DWELLINGS, TO BE DEMOLISHED
- FRONTAGE ALONG AN INTENSIFICATION CORRIDOR

SURROUNDING:

- COMMERCIAL AMENITIES PRIMARILY SOUTH
- INSTITUTIONAL USES/HOLLY COMMUNITY CENTRE
- MUNICIPAL PARK LAND
- STABLE RESIDENTIAL TO THE WEST

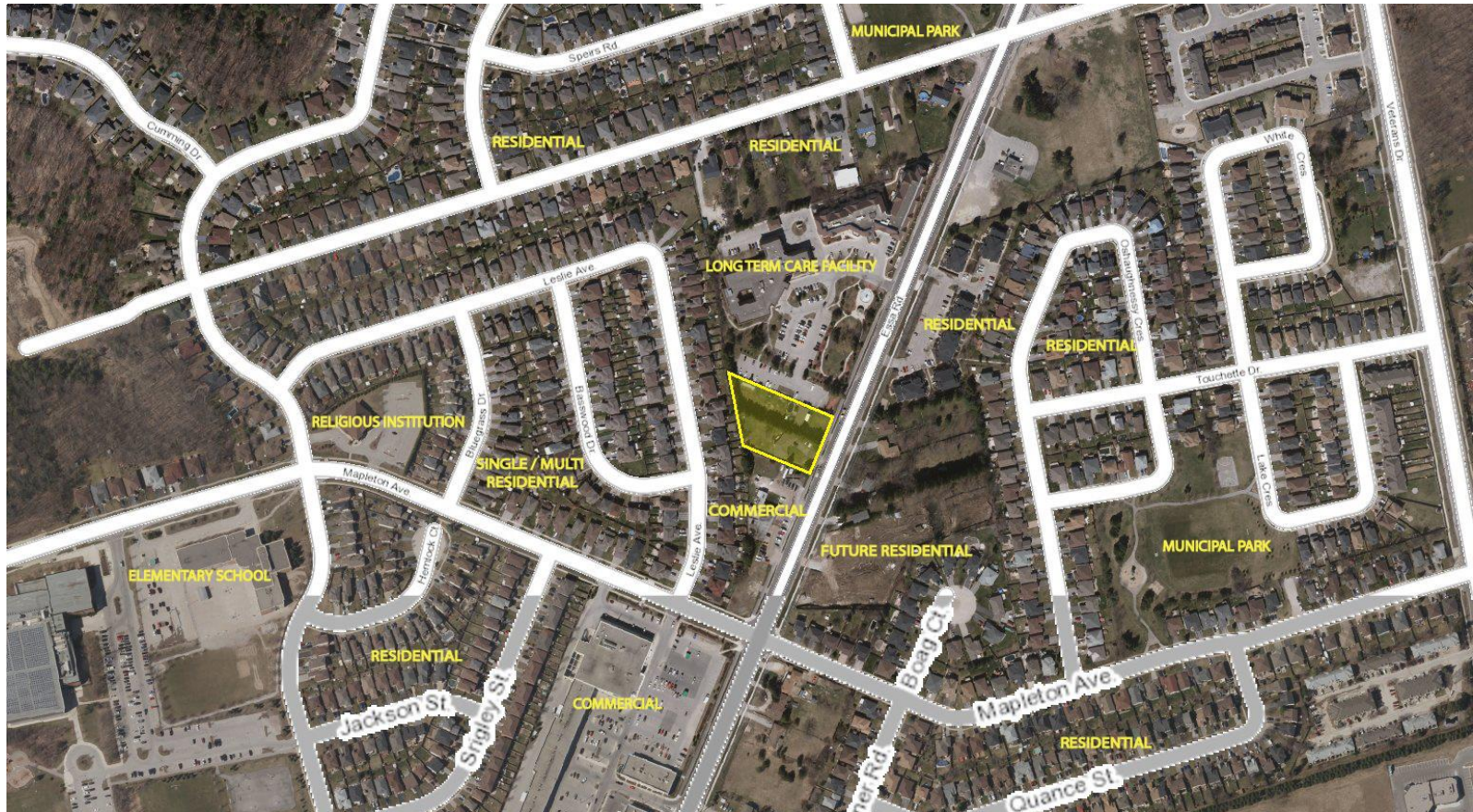

LAND USE DESIGNINATION & ZONING

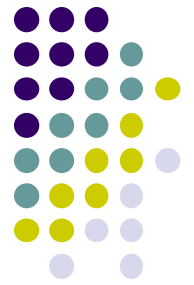

ZONING

RESIDENTIAL
ONE (R1)

LAND USE DESIGNINATION

RESIDENTIAL

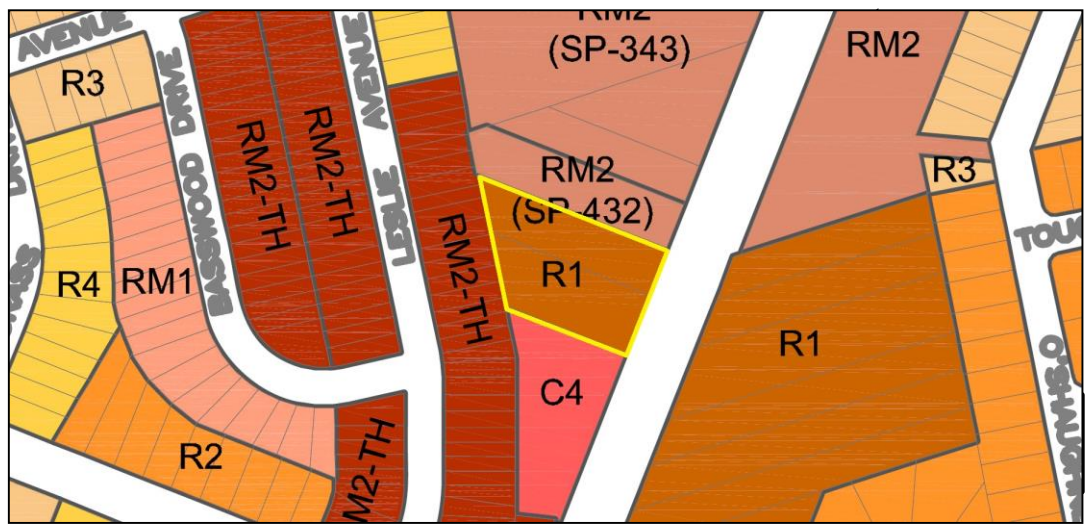



INTENSIFICATION AREAS

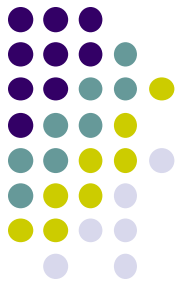

SCHEDULE I Intensification Areas



ENCORE
DEVELOPMENT GROUP

DEVELOPMENT PROPOSAL (ORIGINAL)

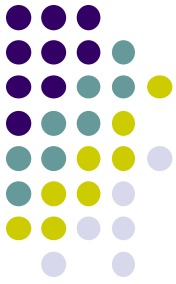

- 48 BACK TO BACK TOWNHOUSE UNITS
- 1.675 PARKING SPACES PER UNIT (INCLUDES VISITOR)
- VEHICULAR ACCESS FROM ESSA ROAD
- FRESH URBAN STREETSCAPE & DESIGN
- INDIVIDUAL AND COMMON AMENITY AREAS (ROOF-TOP)
- PRIVATE WASTE COLLECTION
- FULLY FENCED & LANDSCAPED PERIMETER

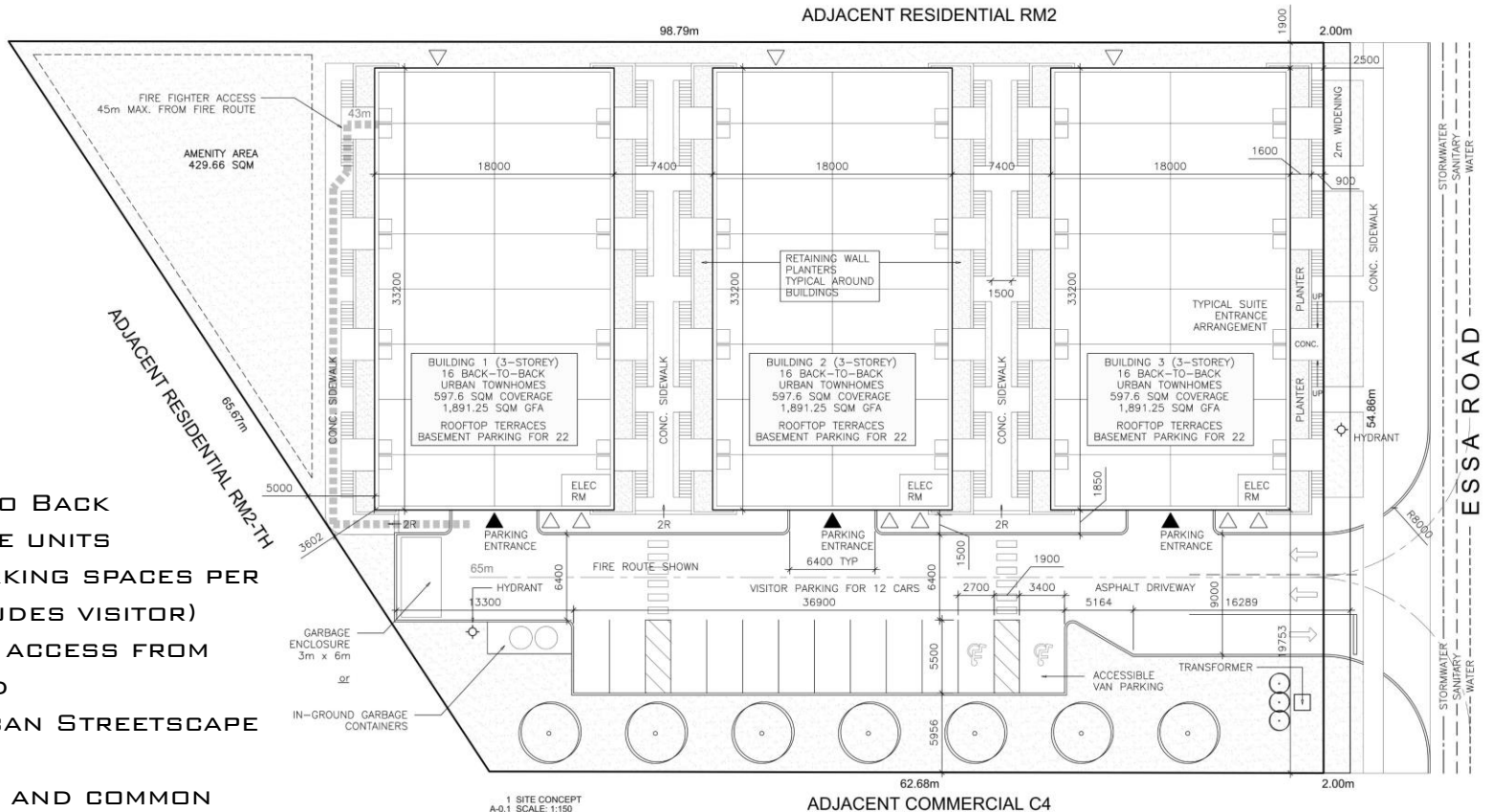



ENCORE
DEVELOPMENT GROUP

DEVELOPMENT PROPOSAL (REVISED)

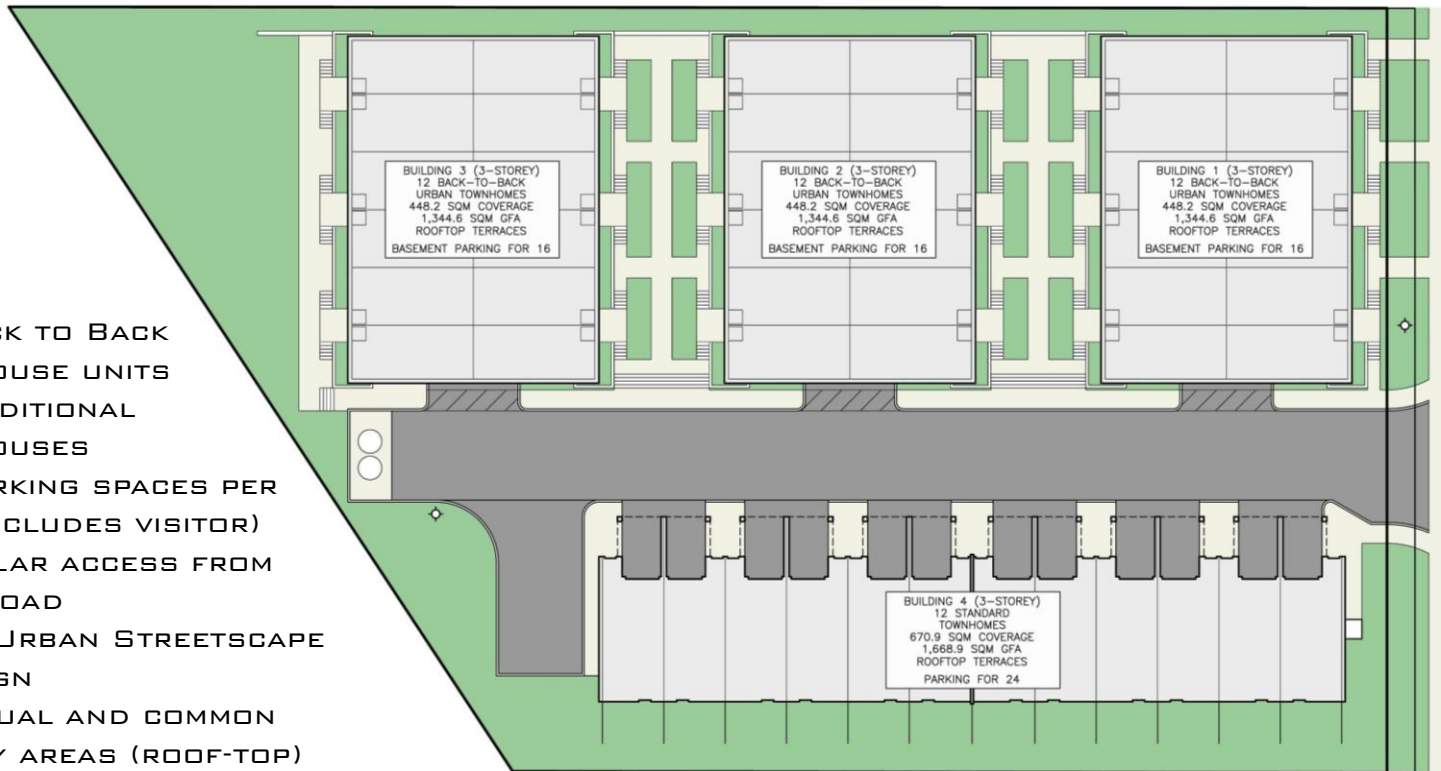
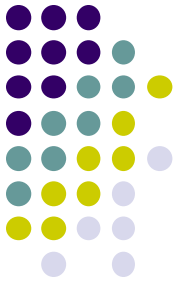

- 36 BACK TO BACK TOWNHOUSE UNITS
- 12 TRADITIONAL TOWNHOUSES
- 1.5 PARKING SPACES PER UNIT (INCLUDES VISITOR)
- VEHICULAR ACCESS FROM ESSA ROAD
- FRESH URBAN STREETScape & DESIGN
- INDIVIDUAL AND COMMON AMENITY AREAS (ROOF-TOP)
- PRIVATE WASTE COLLECTION
- FULLY FENCED & LANDSCAPED PERIMETER



INNOVATIVE PLANNING SOLUTIONS

PLANNERS • PROJECT MANAGERS • LAND DEVELOPERS



ENCORE
DEVELOPMENT GROUP

DEVELOPMENT PROPOSAL (REVISED)

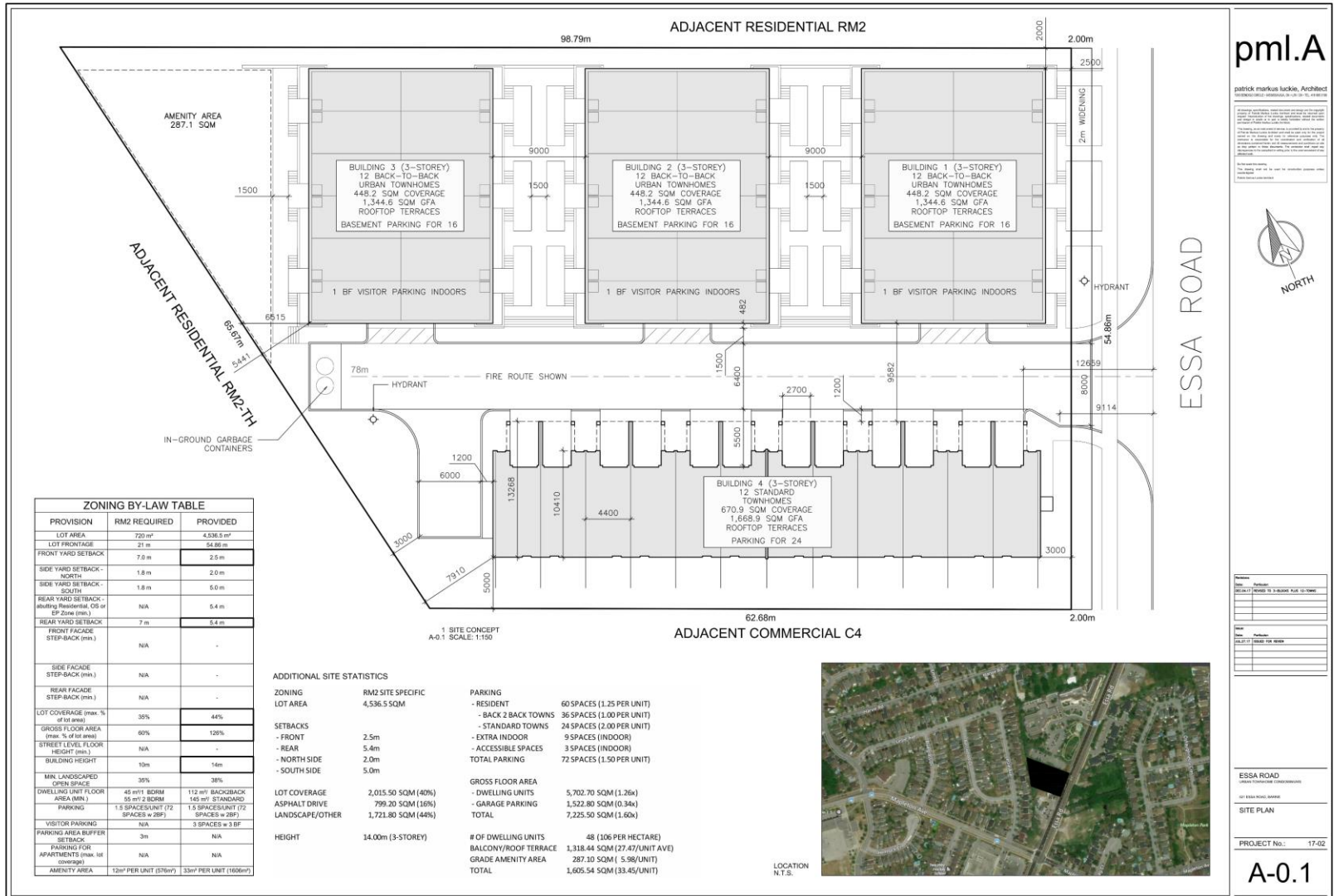
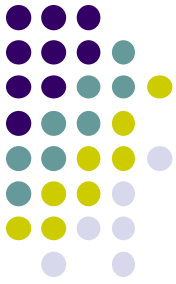



ARCHITECTURAL RENDERING

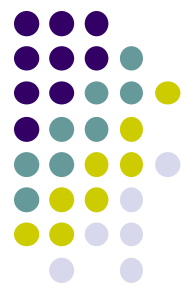

— ESSA ROAD





ARCHITECTURAL RENDERING

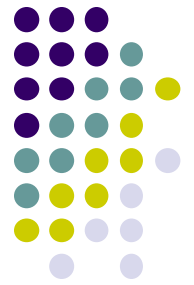

ESSA ROAD



ESSA ROAD - TOWNHOME CONCEPT



ENCORE
DEVELOPMENT GROUP

PROPOSED AMENDMENT

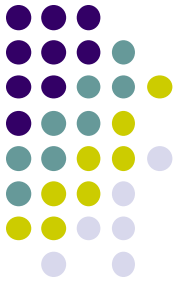

ZBL 2009-141 & By-law 2015-097 (Mixed Used zones)	(RM2) Zone REQUIRED	Mixed Use Corridor (MU-2) Zone REQUIRED	PROVIDED RM2 (SP-MU2)
LOT AREA (min.)	720 m ²	N/A	4,536.5 m ²
LOT FRONTAGE (min.)	21 m	N/A	54.86 m
FRONT YARD SETBACK (min.)	7 m	1 m for 75% of frontage (min.) & 5 m for 25% of frontage (max.)	2.5 m
FRONT FACADE STEP-BACK (min.)	N/A	45 deg. angular plane at height above 80% equivalent of ROW using 3 m min. step-back	N/A
INTERIOR SIDE YARD SETBACK (min.)	1.8 m	3 m (max.)	2.0 m
SIDE FACADE STEP-BACK (min.)	N/A	If adjacent to an OS zone, 5.5 m at height above 80% equivalent of ROW	N/A
REAR YARD SETBACK (min.)	7 m	7 m (abutting R, OS, EP zones)	5.4 m
REAR FACADE STEP-BACK (min.)	N/A	45 deg. angular plane above 7 m using 3 m min. step-back	N/A
LOT COVERAGE (max.)	35 %	N/A	44 %
DENSITY (max.) Block/Cluster/Stacked Townhouses	40 upha	N/A	106 upha
GROSS FLOOR AREA (max. % lot area)	60 %	N/A	126 %
AMENITY SPACE (min.)	576 m ² (12 m ² per unit)	576 m ² (Includes Decks/Balconies) (12 m ² per unit)	287 m ²
LANDSCAPED OPEN SPACE (min. % of lot area)	35 %	N/A	44%
PARKING (min.)	72 spaces (1.5 space per unit)	48 spaces (1 space per unit)	72
ACCESSIBLE PARKING (min.)	2	2	3
HEIGHT (max.)	10 m	16.5 m	14.85 m



ENCORE
DEVELOPMENT GROUP

ACCOMPANYING STUDIES

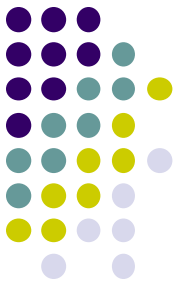

- PLANNING JUSTIFICATION REPORT
 - AFFORDABLE HOUSING REPORT
- FUNCTIONAL SERVICING REPORT
- STORMWATER MANAGEMENT REPORT
- NOISE/VIBRATION IMPACT ANALYSIS
- TREE INVENTORY & PRESERVATION PLAN
- URBAN DESIGN BRIEF



INNOVATIVE PLANNING SOLUTIONS

PLANNERS • PROJECT MANAGERS • LAND DEVELOPERS



CONCLUSION

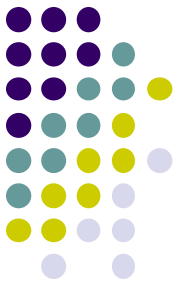

- ZBA APPLICATION IS REQUIRED TO PERMIT THIS 48 UNIT DEVELOPMENT ALONG AN INTENSIFICATION CORRIDOR
- DEVELOPMENT RESPONDS TO COMMENTS FROM PUBLIC AND STAFF AND PROVIDES APPROPRIATE, COMPACT AND RESPONSIBLE GROWTH
- LANDS ARE IDEALLY LOCATED IN CLOSE PROXIMITY TO PUBLIC TRANSIT, MANY COMMERCIAL AMENITIES, MUNICIPAL PARKS, MULTIPLE SCHOOLS, AND OTHER COMMUNITY FACILITIES
- DEVELOPMENT WILL BE SUBJECT TO SITE PLAN CONTROL AND CITY OF BARRIE URBAN DESIGN GUIDELINES TO ENSURE LANDS ARE DEVELOPED TO A HIGH STANDARD
- APPLICATIONS ARE CONSISTENT WITH UPPER AND LOWER TIER PLANNING POLICY AND REPRESENT GOOD PLANNING



